

Roll No. 18491V
 Tel: (023) 8849 700
 E-Mail: gmsig.ias@eircom.net
 Web: www.gurraneasigns.com
 Twitter: @Gurraneasig_NS

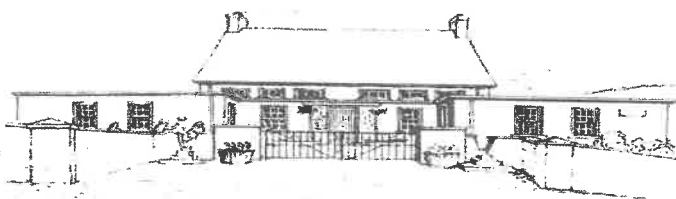

Gurraneasig N.S.
 Kibbritain,
 Co.Cork
 P72 YP78

List of School Activities	Risk Level	The School has identified the following Risk of Harm	The School has the following Procedures in place to address risk identified in this assessment
Training of school personnel in Child Protection matters	High	Harm not recognised or reported promptly	Child Safeguarding Statement & DES procedures made available to all staff DLP & DDLP attended PDST face to face training All Staff viewed Túsia training module & any other online training offered by PDST Principal attended IPPN & CPSMA Seminars BOM records all records of staff and board training
One to one teaching	Med	Harm by school personnel	School has policy in place for one to one teaching Open doors Table between teacher and pupil Glass in window
Care of Children with special needs, including intimate care needs	High	Harm by school personnel	Policy on intimate care
Toilet areas	High	Inappropriate behaviour	Supervision policy
Curricular Provision in respect of SPHE, RSE, Stay safe.	Low	Non-teaching of same	School implements SPHE, RSE, Stay Safe in full - c/f 2 year SPHE Plan
Daily arrival and dismissal of pupils	Med	Harm from older pupils, unknown adults on the playground	Arrival and dismissal supervised by Teachers
Managing of challenging behaviour amongst	High	Injury to pupils and staff	Restraint Policy Health & Safety Policy Code Of Behaviour
Sports Coaches	Med	Harm to pupils	Policy & Procedures in place
Students participating in work experience	Low	Harm by student	Work experience Policy Child Safeguarding Statement.
Recreation breaks for pupils	High	Harm to pupils	Supervision Policy Health & Safety
Classroom teaching	Low	Harm by school personnel	Child Safeguarding Statement & DES procedures made available to all staff
Outdoor Teaching Activities	Low	Inadequate supervision	BOM approves all organised, supervised outings
Sporting Activities	Med	Inadequate supervision	Policy and procedures in place for the use of external sports coaches
School outings	High	Inadequate supervision	BOM approves all organised, supervised outings
Use of toilet/changing/shower areas in schools	Low	Inadequate supervision	Supervision Policy
Annual Sports Night	High	Harm by visitors to school	Child Safeguarding Statement
Fundraising events involving pupils	Low	Inadequate supervision	BOM approves all organised, supervised outings

Use of off-site facilities for school activities	Med	Inadequate supervision	BOM approves all organised, supervised outings
School transport arrangements including use of bus escorts	High	Inadequate supervision	BOM approves all organised, supervised outings
Administration of Medicine	Low	Harm to child by person administering of medicine	Policy and procedures in place for the administration of medicine
Administration of First Aid	Low	Harm to child by person administering of First Aid	Policy and procedures in place for the administration of First Aid
Prevention and dealing with bullying amongst pupils	Med	Bullying	Anti-Bullying Policy
Use of external personnel to supplement curriculum	Med	Harm to child	Child Safeguarding Statement
Care of pupils with specific vulnerabilities/needs such as	Med	Bullying	Anti-Bullying Policy
· Pupils from ethnic minorities/migrants	Med	Harm to child	Code of Behaviour
· Members of the Traveller community	Med	Harm to child	Code of Behaviour
· Lesbian, gay, bisexual or transgender (LGBT) children	Med	Harm to child	Code of Behaviour
· Pupils perceived to be LGBT	Med	Harm to child	Code of Behaviour
· Pupils of minority religious faiths	Med	Harm to child	Code of Behaviour
· Children in care	Med	Harm to child	Code of Behaviour
· Children on CPNS	Med	Harm to child	Code of Behaviour
Recruitment of school personnel including -	Low	Harm not recognised or properly or promptly reported	Child Safeguarding Statement & DES procedures made available to all staff
· Teachers	Low	Harm to child	Child Safeguarding Statement & DES procedures made available to all staff
· SNA's	Low	Harm to child	Staff to view Tusla training module & any other online training offered by PDST
· Caretaker / Secretary / Cleaners	Low	Harm to child	Child Safeguarding Statement & DES procedures made available to all staff
· Sports coaches	Low	Harm to child	Vetting Procedures
· External Tutors / Guest Speakers	Low	Harm to child	Child Safeguarding Statement
· Volunteers/Parents in school activities	Low	Harm to child	Policy of Parents / Volunteers
· Visitors/contractors present in school during school hours	Low	Harm to child	Child Safeguarding Statement
· Visitors/contractors present during after school activities	Low	Harm to child	Policy on Visiting Contractors
Use of Information and Communication Technology by pupils in school	High	Bullying	ICT policy Digital Learning Plan
Application of sanctions under the school's Code of Behaviour including detention of pupils, confiscation of phones etc.	Low	Inadequate Code of Behaviour	Code of Behaviour

Students participating in work experience in the school	Low	Harm to child	Child Safeguarding Statement
Student teachers undertaking training placement in school	Low	Harm to child	Child Safeguarding Statement
Use of video / photography / other media to record school events	Low	Harm to child	Enrolment Policy Child Safeguarding Statement GDPR Data Protection Policy
Past pupils visiting the school for full or partial days	Low	Supervising Children who are not part of the school community / not insured	Insurance Policy Health & Safety Statement
Surfing	High	Inadequate supervision	Policy & Procedures in place
Security/access to school	Med	Harm to child	Health & Safety Statement Sign out Book
Pupils being collected early from school	Med	Harm to child	Sign out Book

Important Note: It should be noted that risk in the context of this risk assessment is the risk of "harm" as defined in the Children First Act 2015 and not general health and safety risk. The definition of harm is set out in Chapter 4 of the Child Protection Procedures for Primary and Post- Primary Schools 2017

In undertaking this risk assessment, the Board of Management has endeavoured to identify as far as possible the risks of harm that are relevant to this school and to ensure that adequate procedures are in place to manage all risks identified. While it is not possible to foresee and remove all risk of harm, the school has in place the procedures listed in this risk assessment to manage and reduce risk to the greatest possible extent.

This risk assessment has been completed by the Board of Management on 26th March 2019. It will be reviewed as part of the school's annual review of its Child Safeguarding Statement.

Signed Mary O'Driscoll

Signed Eoin Fitzpatrick

Date 2/4/2019

Date 26/3/19 2/4/19 EF

Chairperson, Board of Management

Principal/Secretary to the Board

